



## *Eagle Building Supplies (PTY) Ltd*

2015/226449/073

t/a *Eagle Roofs*  
*P.O.Box 3603*  
*Rustenburg, 0300*

*Northwest Province – South Africa*

*Tel nr. : (+27) (0) 14- 592-9665*

*: (+27) (0) 82-381-3284*

*Fax to mail : (+27) (0) 86 606 0553*

*e-mail : [eagleroofs@mweb.co.za](mailto:eagleroofs@mweb.co.za)*

# *Eagle Roofs*

**100% Rated Category “A” Roof Truss Factory - ITC**

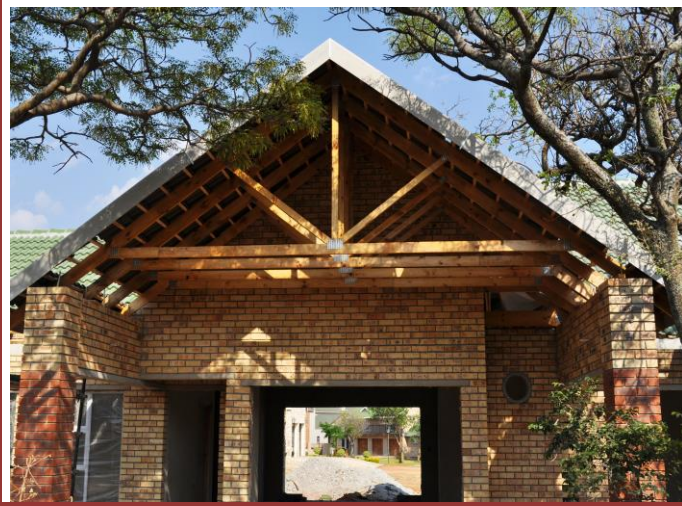

### INTRODUCTION OF OUR COMPANY

*We, as Eagle Roofs, are the proud holders of the Certificate of Competence no. COC/450/MIT with a Category A grading. Category A grading allows Eagle Roofs to quote and design any and all category buildings. Eagle Roofs scored 100% during our latest audit from the Institute for Timber Construction South Africa (ITC-SA). Attached to this introduction is our Certificate of Competence - COC/450/MUL for your attention.*

**The offices and Factory of Eagle Roofs are situated on the corner of Line and First Street, Waterval East, in Rustenburg. (near the Shell Ultra City on the R24).**

At the moment, with all the machinery at our disposal, the factory is capable of producing 1000m<sup>2</sup> roofs per day under a production area of 1300m<sup>2</sup>.

Leading the Eagle Roofs-team is **Johan Grundling**, with more than 26 years' experience in the design and manufacturing of pre-fabricated timber trusses, and now also light steel trusses. With more than 30 years of experience in the building trade, Johan gives total peace of mind to all his clients, as all trusses are designed and manufactured by implementing strict international guidelines. With a strong business and a production team, Eagle Roofs are looking forward to the future and a fruitful relationship with your company.

**Johan and JC Grundling** will handle all the designs for the manufacturing, whilst the representatives, **Denis Swanepoel, and Chokie Gopane** will be looking after all your needs in the following categories: - Quotations, measurement of buildings before manufacturing, client services and all queries you may have regarding your roof. **Eugene Grundling** will be handling your deliveries, which, under normal situations, will always be on time. **Verna Grundling**, as Financial Manager, will look after all financial aspects. At our reception, **Karlien Grundling**, PA to Johan will assist with all appointments and make you feel welcome and at home, with her warm personality. **Roelien Lourens** assist Verna at finance department



*Light Galv. Steel Trusses)*

*Timber Trusses*

*Eagle Roofs is, at the moment, a level 4 BEE contributor.*

Only SANS approved materials are used and the workmanship are of the best quality, combine that with on-time deliveries and you will have the pleasure of feeling the Eagle Roofs' service.

Johan started Eagle Roofs in 2002 as a small business and has since grown in size and stature.



Eagle Building Supplies t/a Eagle Roofs is manufacturing prefabricated timber trusses, under the licenced of **Multinail Africa**, a leader in the roofing industry. Multinail Africa lay down strict guidelines and make sure that they are followed by the book. Multinail Africa supplies specialised services, which allows us to deliver an even better and more specialised service to you the customer.

**Eagle Roofs** provides with every roof delivered a **certificate** that specifies that great care was taken in designing and manufacturing the roof according to all SANS standards.

Specialised computer programmes are used for the design of the trusses and the calculation of all materials needed for your specific roofing needs and a drawing for the erecting of your roofing structure, according to SANS codes **10160, 10163 and 10243**. Advice and quotations, regarding roof trusses and accessories, are given free of charge. Manufactured trusses and accessories, including a well-detailed roof-layout as mentioned above, are also delivered at a minimum cost as indicated below.

We deliver not only to Rustenburg, but also within a radius of 450km from Rustenburg. We have successfully delivered structures to **Burgersfort, Steelpoort, Leydenburg, Ellisras, Taung, Kuruman, Vryburg, Mahikeng, Petrusville in the Free State, Botswana and as far as Sodwana in Kwazulu Natal.**

**Eagle Roofs is thus supplying the following and more:**

1. **Pre-fabricated timber trusses**, (Duo-pitch, Mono-pitch, Polynesian, Attic, Inverted, Asymmetric, Scissor, Half Scissor, Modified Scissor and Gambrel)
2. **Pre-fabricated light steel trusses** , (Duo-pitch, Mono-pitch, Polynesian, Attic, Inverted, Asymmetric, Scissor, Half Scissor, Modified Scissor and Gambrel)
3. **Stabilising materials**. Bracing ect.
4. **Wallplate**,
5. **Barge boards and fascia boards**,
6. **Roof covering** – cement tiles, metal tiles or metal sheeting with all fittings if needed,

7. **Metal hangers** – Ezi products
8. **Roof underlay** – Sisalation, Alububble or 400 micron membrane,
9. **Wire nails and bolts** where needed.

Light Steel Trusses by others

We also stock the **Easyflash** waterproofing on demand. This product originated from **Germany** and is locally distributed in three colours: - **Brown, Terracotta and Slate.**

As mentioned, we also supply light weight steel trusses. These light steel trusses are manufactured from pre-rolled galvanised steel and are economically affordable and complies with all the necessary SANS codes and standards. With the shortage of good timber and veldfires destroying plantations, these will be the roofs of the future and a good alternative. For all further enquiries, do not hesitate to call for more info.



**Included in our list of clients are the following well-known names: - Murray & Roberts, Xstrata Mining Group, Impala Mines, Lonmin Mines, Amplats, WBHO and Grinaker.**

None of these names needs introduction in the South African building trade. **We hope to add your business to our growing list of satisfied customers.**

We target from the homeowner to large developers and are proud to include the following projects successfully supplied.

Hospital at Amandelbult for Amplats Mines,  
 Training centres at Rasimone mine and Sataria – Amandelbult  
 Offices, ablutions and security buildings at UG2 Waterval Rustenburg and Tweefontein mine Steelpoort,  
 Mine Offices at Waterval Rustenburg,  
 Shopping Centre at Northam,  
 Library at Rustenburg North,  
 Many schools in the Northwest and Limpopo provinces,  
 Security Buildings at Losperfontein Correctional Service – Brits,  
 Refurbishment of new trusses to Lichtenburg Prison with a special design to hinder escapes from facilities,  
 National Intelligence Service's Library at Mahikeng,  
 Recreation Centre at Bothaville,  
 Fire station at Schweizer-Reneke,  
 RDP Housing in Mahikeng and surrounding area,  
 Several Community Halls in the Northwest Province, Northern Cape Province and Free State,  
 New additions to Job Thabane Hospital in Rustenburg,  
 New Cafeteria and Restaurant at Sun City,  
 Mahikeng Nursing Collage,  
 Different flats, security buildings and other normal complexes.

Although we quote for the manufacturing of trusses and not for the erecting of the roofs, we can supply you with a list of qualified roof erectors for your convenience.

We are waiting for your call.

*We can't direct the wind, but we can adjust our sails!*



All fully detailed plans should be faxed to **086 6060 553** or e-mailed to [eagleroofs@mweb.co.za](mailto:eagleroofs@mweb.co.za) in pdf format for a full quotation.

**Nothing is too small or too big.**